

IMPRESSIVE
IN EVERY VALUE

Developers
PRADHAN DEVELOPERS

Contact details
97260 80801
97120 80801

Site Address
"Pradhan Glenwoods"
30 mtr Bhayli - Sevasi Canal Road,
Near Priya Talkies, Sevasi TP-2, Vadodara.

Rera Reg. No. : PR/GJ/VADODARA/VADODARA/Others/MAA07728/021220
Website :- www.gujrera.gujarat.gov.in

Architect -	Structure	Legal consultant
Ambica consultants	Zarna Associates	V.M.Pradhan

PRADHAN 
GLENWOODS

2 BHK ULTRA-LUXURIOUS APARTMENTS



GREAT...
LOCATION

QUALITY...
CONSTRUCTION

THOUGHTFUL...
PLANNING

AFFORDABLE...
PRICING

DOOR TO THE BEAUTIFUL
FUTURE OPENS HERE....

step in.. as a whole new world of harmonious living awaits you.





PRADHAN
GLENWOODS

Some say that royalty is restricted to the royals. It's time to prove it a myth with Pradhan Glenwoods 2 BHK ultra-luxurious apartments where each unit is an epitome of imperial aura. Housing the finest luxuries of life in abundance... it invokes the majestic streak hidden deep within all of us!





Foyer with Meeting area



Value Added Amenities



Allotted parking



Automatic Entrance Gate



24 hrs Hot Water in all Baths



Covered AC Gym



Terrace Garden Sit-out with Gazebo



2 Elevators in each tower



BASEMENT FLOOR PLAN

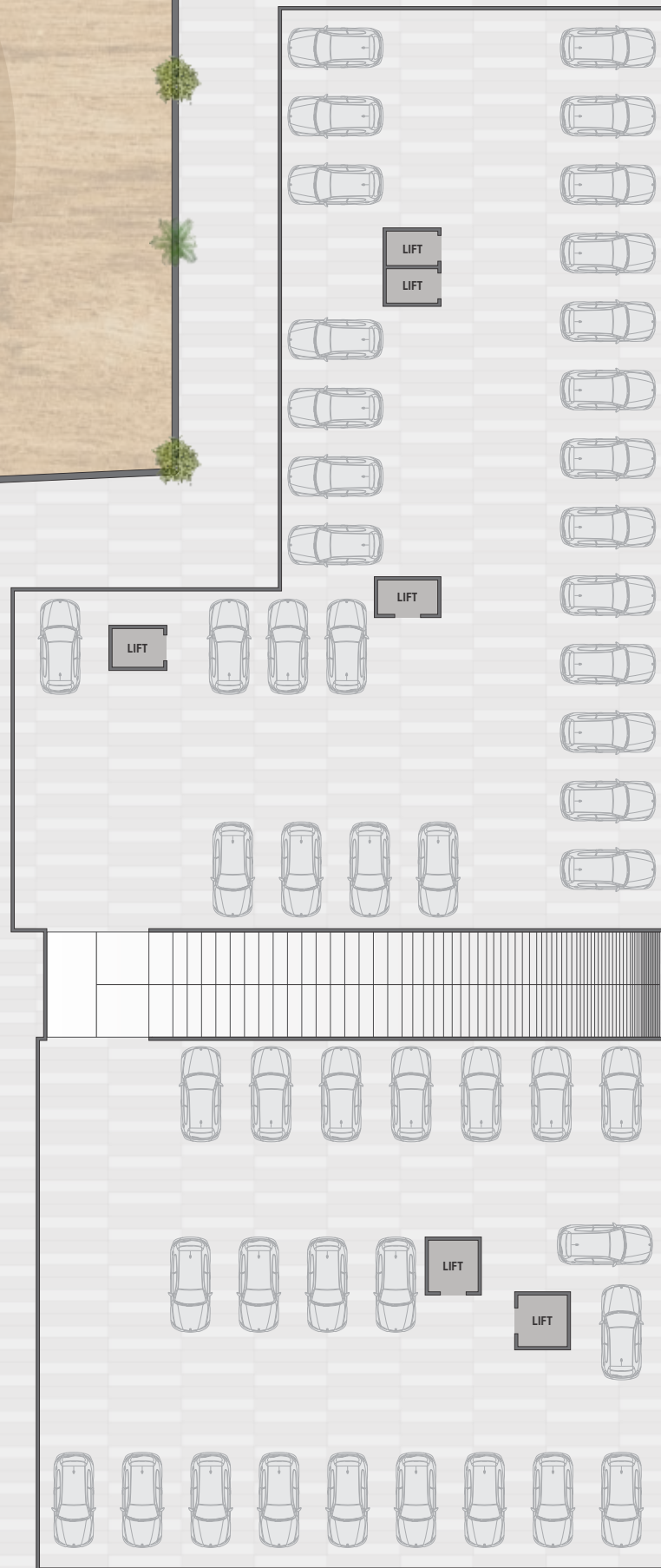

18. MTR WIDE TP ROAD



GROUND FLOOR PLAN



18. MTR WIDE TP ROAD



Where lavishness
is spread
everywhere!



TERRACE FLOOR PLAN





TYPICAL FLOOR PLAN

2 BHK Typical Floor Plan

Tower A, B & C



18. MTR WIDE TP ROAD



AMENITIES

- Entrance lobby with meeting area in every tower
- Solar panels for efficient power usage
- Water sprayer in parking area for vehicle wash
- Security cabin with CCTV surveillance
- Generator for power back up
- 2 Points in each apartment connected with generator in case of power failure
- AC & TV Points in bedrooms and living area
- USB port for charging
- Designer water bodies
- Rain water harvesting
- Anti termite treatment
- Provision for Gas pipeline
- Separate underground and overhead tanks with sensors
- Individual letterbox and elegant nameplates
- AAC Block construction for heat reduction
- Lighted project name shield
- Yoga deck
- Video Door Phone

SPECIFICATION



STRUCTURE

Earthquake resistant RCC frame structure as per structural design.



KITCHEN

Granite platform with SS sink & premium branded wall tiles dado up to lintel level.



WALL FINISH

Internal smooth plaster with wall putty. Exterior surface plaster with cement paint.



BATHROOM

Designer tiles up to lintel level with branded ceramic & plumbing fittings.



FLOORING

Vitrified tiles flooring in all rooms with skirting.



PLUMBING

Internal concealed plumbing with good quality C. P. Fittings.



DOORS

Decorative main door as per architect's design with standard fittings. All internal doors made of good quality flush doors with laminate.



ELECTRIFICATION

Concealed ISI mark copper wiring with Good quality modular switches.



WINDOWS

Color anodized / powder coated Aluminium Windows

PRADHAN GLENWOODS



KEY PLAN



In The Vicinity of 10 Mins.

Bansal Mall
Priya Talkies
Hyatt Place

Akshar Public School
Navrachna School
Mahadev Temple

Bright Day School
D-Mart
Waves Club

Payment Mode :- 10% - At the time of Booking | 15% - 15 Days from date of Booking
7% - At time of Basement & Foundation | 7% - Plinth Level | 7% - At every Slab (8)
4% - Masonry & Plaster | 4% - At time of Flooring & Color | 5% - Before Sale Deed

Booking cancellation amount 50,000/-
Amount will be refunded from new booking of same flat

Notes :- (1) External changes are strictly not allowed (2) Development charges, stamp duty documentation charges, and all Government or municipal taxes, GST, MGVC meter deposit should be levied separate (3) Possession will be given after one month of all settlement of account (4) Extra work at the cost of client with prior estimate needs to be given in advance but no changes in elevation and plan will be done (5) While every reasonable care has been taken in preparing this brochure and can not form part of an offer, contract or agreement. The promoter can not be held responsible for any inaccuracy in this contents. (6) All plans, information and specification are subject to changes may be required by the promoters. (7) Payment schedule must be followed strictly, any delay in payment shall incur penalty. (8) Actual Dimensions may vary as per the site conditions. (9) Amenities and specification are not consider in shops.

Disclaimer : the details, facts, specifications, figures mentioned in brochure are indicative for information purpose only and subject to modifications / compliance required as per RERA act.